



Operating Instructions



Art.-Nr. CJ-AT-A

CJATA.01.01

Operation

⚠ CAUTION

If parts of the scope of delivery are missing or damaged, the device must not be used.

Inflate

1. Spread out the mat completely at the desired location. Make sure that there is enough space around the mat.

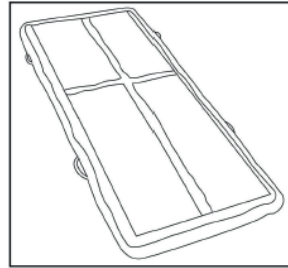

2. Connect the pump to the mat.

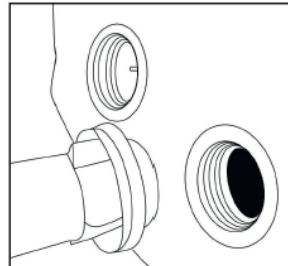

3. Turn on the pump.

⚠ WARNING

Let air into the mat until the desired strength is achieved. However, remember not to "overfill" the mat, as this can cause damage to the article and personal injury.

4. Disconnect the air pump from the mat.

5. Close the valve of the mat.

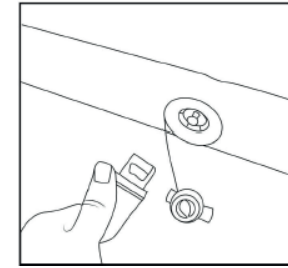

Deflate

1. Connect the pump to the mat.
2. Adjust the controller of the pump accordingly.
3. Switch on the pump.
4. Put the mat back together after all the air has escaped and close the valve.
5. Pack the mat in the supplied carton.

Description

An AirTrack is a mat that is filled with air. It is made of robust and durable materials and has various applications. This mat has many advantages compared to conventional floor runners or other gym mats. Unlike inflatables, AirTracks are filled with air only once and are then ready for use. There is no need to have a fan on all the time and you don't have to refill air every few minutes.

General Safety Instructions

- + Children should not be allowed unattended near the device and the pump.
- + The pump may only be connected directly to a grounded power outlet using the power cable supplied. Extension cables must comply with VDE guidelines. Always unwind the power cord completely.
- + The power outlet must be protected by a fuse with a minimum fuse rating of "16 Ampere".
- + Do not change anything at the power cable or the power plug.
- + Keep the pump and the power cord away from water, heat, oil and sharp edges.

- + Check the condition of the floor before each use of the article.
- + This pump is not designed for continuous use. Prolonged use for more than 30 minutes can cause overheating and damage to the pump.
- + Never leave the pump unattended while it is in operation.
- + Do not use the pump when it is wet.
- + Never let sand, small stones etc. be sucked into the fill/drain port when using the pump.
- + Never look inside the pump or point the fill/drain port towards your eyes when the pump is operating.
- + Never try to insert your hand or fingers into the valve.

Care, Maintenance and Storage

⚠ WARNING

The storage location should be chosen so that improper use by third parties or children can be prevented.

1. Clean the device with a dry soft cloth.
2. Store the device in the supplied carton in a dry environment.

Repairing a hole

1. Get a PVC-compatible adhesive and PVC patches.

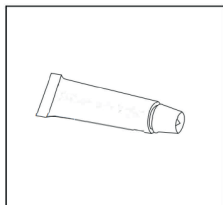

2. Make sure there is no air left in the Air Track.

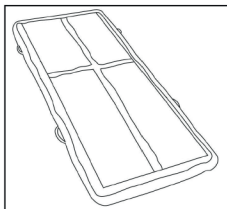

3. Cut the PVC patch so that it completely covers the hole.

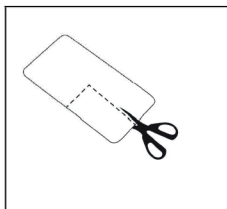

4. Apply some glue around the hole and on the patch.

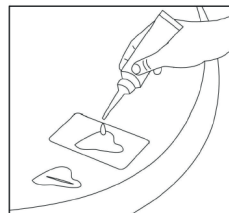

5. Use a hair dryer to heat the glue.

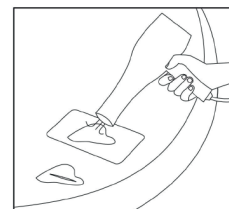

6. Place the PVC patch on the hole and press it firmly. There must not be any air bubbles.

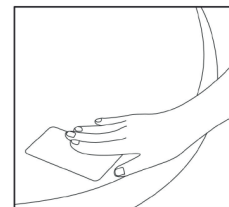

7. Wait 24 hours before refilling the article with air again.

Warranty Information

Training equipment from cardiojump® is subject to strict quality control. However, if a fitness equipment purchased from us does not work perfectly, we take it very seriously and ask you to contact our customer service as indicated. We are happy to help you by phone via our service hotline.

Warranty period

The warranty periods, shown on our web shop, begin on delivery of the fitness equipment. The respective warranty periods for your equipment can be found on its product website.

Please refer to the website of your cardiojump® device for the exact warranty conditions.

Contact

DE

Technical Support

☎ +49 4621 4210-900

✉ technik@sport-tiedje.de

Service

☎ 0800 20 20 277

(freecall)

✉ info@sport-tiedje.de

UK

Technical Support

☎ +44 141 876 3986

✉ support@powerhousefitness.co.uk

Service

☎ +44 141 876 3972

FR

Technical Support & Service

☎ +33 (0) 172 770033

+49 4621 4210-933

✉ service-france@fitshop.fr

DK

Technical Support & Service

☎ 80 90 16 50

+49 4621 4210-945

✉ info@fitshop.dk

INT

Technical Support & Service

☎ +49 4621 4210-944

✉ service-int@sport-tiedje.de

BE

Technical Support & Service

☎ 02 732 46 77

+49 4621 42 10-932

✉ info@fitshop.be

NL

Technical Support & Service

☎ +31 172 619961

✉ info@fitshop.nl

AT

Technical Support & Service

☎ 0800 20 20 277

(freecall)

+49 4621 42 10-0

✉ info@sport-tiedje.at

CH

Technical Support & Service

☎ 0800 202 027

+49 4621 42 10-0

✉ info@sport-tiedje.ch

PL

Technical Support & Service

☎ 22 307 43 21

+49 4621 42 10-948

✉ info@fitshop.pl